

HYTO MED User Manual



HYTO GmbH

Hochfeld 242

A - 5721 Piesendorf

Tel.: +43 660 23 70 221

Mail.: info@hyto.at



Table of contents

General Information.....	3
Preface.....	3
Purpose	3
Specification	3
Declaration of conformity.....	4
Disclaimer.....	4
Safety Instructions	4
Product and delivery information.....	5
Checking the delivery.....	5
Identification and nameplates	6
Requirements for assembly	6
Steps of installation	7
Installation video.....	8
HYTO System.....	8
Nameplate.....	8
Maintenance instructions.....	9
Technical data	9
Note on materials	9
Customer feedback.....	10
Guarantee notice	11

General Information

Preface

Thank you for choosing HYTO MED.

Our HYTO MED can be mounted quickly and easily on almost any standard ceramic WC and offers an increase in seating position of about 12cm.

The HYTO system hinge offers a stable hold and is still easy to clean. The seat can be simply folded up for maintenance cleaning and quickly removed for basic cleaning. The ergonomically shaped seat makes it easy to get up.

Please read these instructions for use carefully before using for the first time.

It contains important safety instructions and valuable tips on the correct installation and care of the booster seat. If you have any further questions or suggestions, please do not hesitate to contact our service department or your local dealer.

Purpose

HYTO MED is suitable for toilet use by persons weighing up to 140 kg. The raised seat is not suitable for use as a seat.

Specification

The supply of toilet assistance is indicated for persons with

- Lack of trunk control
- Hip and spine stiffeners
- Restricted movement due to hip prostheses
- Restricted mobility or muscle strength.

Declaration of conformity

For the HYTO MED toilet seat, HYTO GmbH declares under its sole responsibility that it conforms to EC Directive 93/42 for medical products. The tests and expert opinions on which this declaration is based can be requested from and explained by your specialist dealer.

Disclaimer

HYTO GmbH shall only be liable if the products are used under the specified conditions and for the specified purposes. We recommend to handle the products properly and to maintain them according to the instructions. HYTO GmbH is not liable for damage caused by external influences and improper handling. If you yourself are not able to install the HYTO system hinge properly, please contact your dealer.

Safety Instructions

If the toilet seat elevator is used in accordance with its intended use, there is no danger.

The maximum user weight is 140 kg.

Parts of clothing or the body may become trapped when sitting down. When standing up, look out for any trapped clothing.

Make sure that the hinge is firmly seated and that the retaining clip engages properly.

Make sure that the ceramic WC is correctly installed. If in doubt, consult a specialist.

Product and delivery information

Checking the delivery

- The toilet seat booster is completely packed in a cardboard box.
- Please check the contents to ensure that they are complete and undamaged.

The content consists of:

- - 1 outer package
- - 1 toilet seat booster pre-assembled *
- - 1 retaining clip
- - 1 HYTO system hinge in extra PE bag **
- - 1 instruction manual

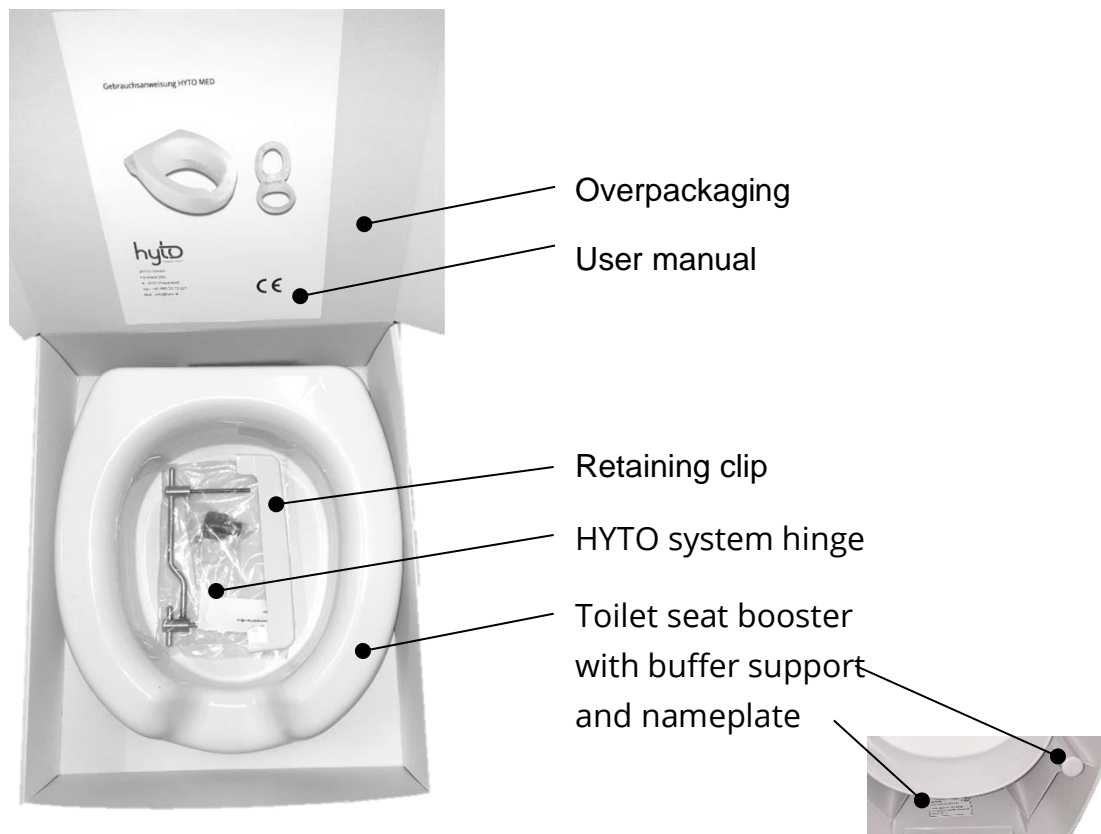

* pre-assembled with 4x buffer and model plate

** HYTO system hinge not included with HYTO MED Modular

Identification and nameplates

Type and manufacturer's plate is attached to the rear inner wall and is visible when the seat is folded up. Please ensure that the nameplate is legible and remains on the seat. This is necessary for the identification of the product and must not be removed.

Requirements for assembly

The toilet seat riser can be mounted on any standard ceramic WC.

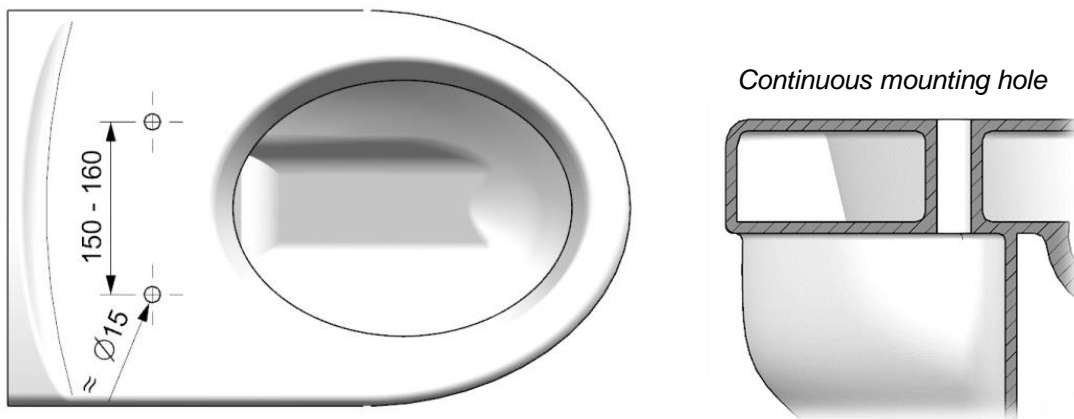

With newer ceramic WCs, "installation from above" may be necessary. Please ask your specialist dealer about the "HYTO TOP Mounting" hinge!

The distance between the mounting holes of the ceramic WC and the rear wall should be at least 10 cm so that the seat can be folded up for easy maintenance cleaning.

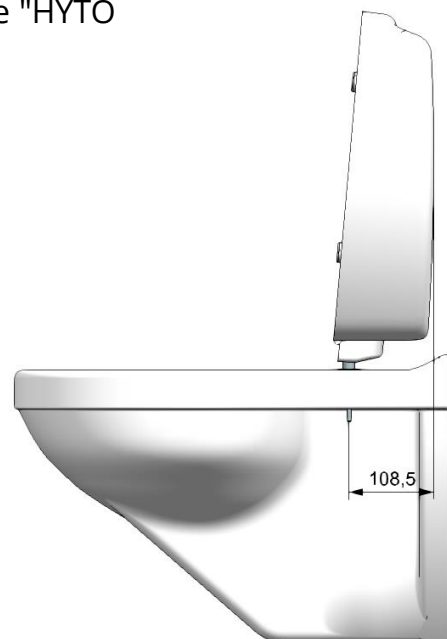

Steps of installation

If necessary, unscrew your existing WC seat from the ceramic and fit the HYTO System hinge. Place the support disc and sealing disc from above.

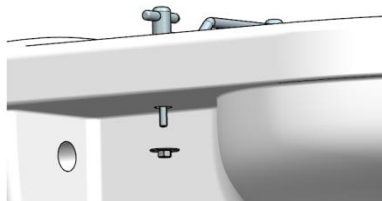

M6 (2x)

Place the washer and nut at the bottom and tighten the nut slightly.

Slide the HYTO booster seat to the side. Align the position of the booster cushion with the ceramic and tighten the fixing nut with the tool provided.

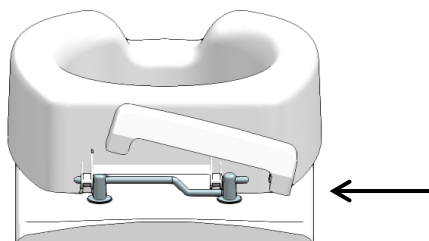
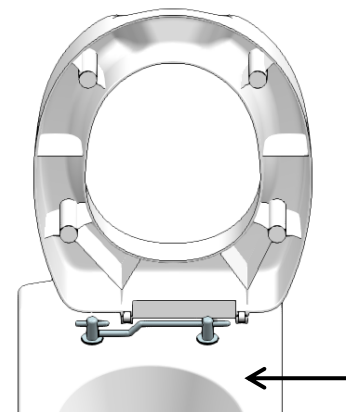

Place the retaining clip on the side and slide it onto the hinge bar. Fold the clip onto the hinge until you hear a snapping sound.

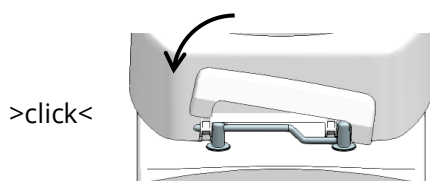

The HYTO booster seat is completely assembled!

In order to remove it for cleaning, unfold the clip in reverse order and wipe off to the side. The HYTO Seat Raiser can be pushed to the side.

Installation video

For a detailed assembly video please visit our homepage >www.hyto.at< or scan this QR code to get to the YouTube link.



<https://www.youtube.com/watch?v=fbyTILclFyc>

HYTO System

The HYTO system hinge makes it easier to switch between the raised seat and a normal WC seat. Please ask your dealer about the HYTO Modular System or visit our homepage for more information.

Nameplate

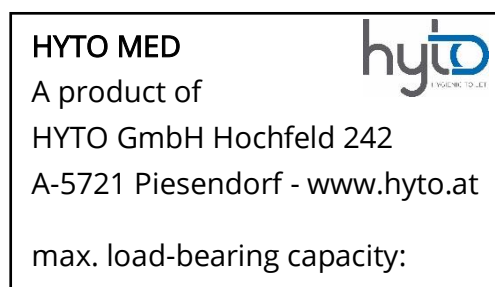

Maintenance instructions

The HYTO booster seat is made of PP material and is therefore resistant to all common chemical cleaners. Please do not use cleaning agents with abrasive additives or microfibre cloths to avoid damaging the surface.

For cleaning, use normal soapy water or mild, natural detergents. Do not use abrasive cleaning agents or scratching cleaning sponges, as these can attack the surface. Rinse with water and dry with a soft cloth.

WC-seat fastening parts (hinges) should not come into contact with ceramic WC cleaning agents or must always be cleaned with pure water to avoid rust spots!

HYTO MED can be safely cleaned in industrial sinks up to 60°.

Technical data

GTIN number	9120087750108
Seat surface width [cm]	37,5
Seat surface depth [cm]	41
Increasing the seating position [cm]	approx. 12
Opening L x B [cm]	28 x 23
Maximum load-bearing capacity [kg]	140

Note on materials

The HYTO booster seat and retaining clip are made of PP + 20% Talcum powder. The material has been tested for harmlessness by TÜV Rheinland. You can request the test certificate from your dealer or go directly to our homepage at www.hyto.at

✂

Customer feedback

As an upcoming company, we are very dependent on feedback from our customers.

We look forward to every suggestion, request or, if necessary, complaint!

Guarantee notice

Warranty services relate to all product defects that can be proven to be due to defects in material or fabrication. The warranty period is 24 months from receipt of the notification of readiness for shipment and at the latest after delivery. Excluded from the warranty are damages caused by natural wear and tear, intentional, negligent or improper use. The same applies if unsuitable cleaning agents, lubricating oils or greases are used. In case of a reclaim, the fully filled out warranty section (below) must be submitted with the product.



Guarantee - Section

Product:

Model name

Serial number

Specialised dealer:

Date and Stamp

Send to:

HYTO GmbH
 Hochfeld 242
 A-5721 Piesendorf
 AUSTRIA

